

PAGE - 162

Jos. Warfel

A-79-80

C-171-193

Sam Buck  
A-79-67

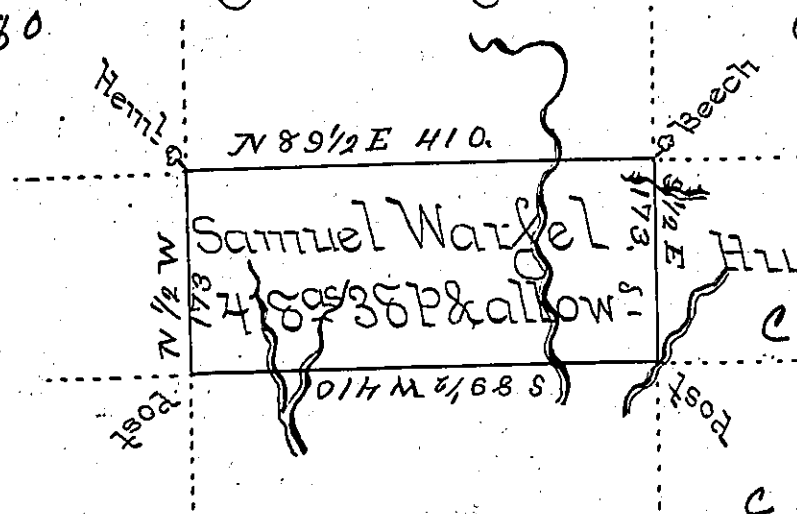

Hu. Prichard  
C-171-192

A-77-82

C-68-202

James Warfel

PAGE - 100

Draft of a tract of land called \_\_\_\_\_ situate in the County of Luzerne, containing four hundred and Eighteen acres 35 Per<sup>s</sup> and Allowance ~~of six~~ surveyed for Sam<sup>l</sup> Warfel the 4<sup>th</sup> Day of Nov<sup>r</sup> 1791 in pursuance of a Warrant dated the 26<sup>th</sup> Day of July 1791

by Wm Gray U.S.

To Daniel Brodhead Esq<sup>r</sup> }  
 Surv<sup>r</sup> Gen<sup>l</sup> ~ }

IN TESTIMONY that the above is a copy of the original remaining on file in the Department of Internal Affairs of Pennsylvania, made conformably to an Act of Assembly approved the 16th day of February, 1833, I have hereunto set my Hand and caused the Seal of said Department to be affixed at Harrisburg, this fourth day of July 1899.



*James H. Pitts*  
 Secretary of Internal Affairs.